



D-302416

English

KF-234 PG2

PowerG Wireless 2-Way Keyfob



Visonic

Installation Instructions

1. INTRODUCTION

KF-234 PG2 is a miniature PowerG 4-button (6-function) keyfob, designed for use with PowerG control panels.

Transmission is initiated by pressing any one of the four recessed pushbuttons. Upon pressing a specific button, the KF-234 PG2 transmits a PowerG message associated with the button that was pressed and identifiable by PowerG control panels.

A red LED lights during transmission. When an identified command is received by the PowerG control panel, it acknowledges the command. Upon acknowledgement, the green LED lights and a happy beep is heard to indicate successful completion of the command or the red LED lights and a sad beep is heard to indicate that the control panel cannot perform the command.

In addition, a battery report is transmitted with the outgoing message. PowerG control panels are designed to identify this report and operate a corresponding output, if required.

Each keyfob is supplied with a small key ring.

Note: For UL Listed Product, Panic is for Ancillary Use only.

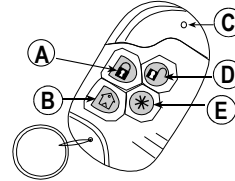

- A. ARM "AWAY"
- B. ARM "HOME"
- C. LED
- D. DISARM
- E. AUX

Figure 1: External View

2. ENROLLMENT AND CONFIGURING THE KEYFOB PARAMETERS

2.1 Enrollment

Refer to the PowerMaster panel's Installer Guide and follow the procedure under the "02:ZONES/DEVICES" option of the Installer Menu. A general description of the procedure is provided in the following flow chart.

Step 1	Step 2	Step 3	Step 4	Step 5
Enter the Installer menu and select "02:ZONES/DEVICES"	Select "ADD NEW DEVICE" Option See Note [1]	Enroll the device or Enter the device ID	Select the desired Zone Number	Configure the Keyfob
02.ZONES/DEVICES	⇒ ADD NEW DEVICES ⇓ MODIFY DEVICES	⇒ ENROLL NOW or ENTR ID:XXX-XXXX	⇒ F05:Keyfob ⇒ ID No. 300-XXXX	⇒
⇒ means scroll ▶▶ and select OK				See Note [2]

Notes:

[1] If the keyfob is already enrolled you can configure the keyfob parameters via the "Modify Devices" option – see Step 2.

[2] Select the "Device Settings" option and refer to section 2.2 to configure the keyfob parameters.

2.2 Configuring the Keypad Parameters

Enter the **DEVICE SETTINGS** menu and follow the configuration instructions for the KF-234 PG2 keyfob as described in the following table.

Option	Configuration Instructions
BUTTON A (*)	<p>Here you select the function of the AUX button on the keyfob device.</p> <p>Status: Control panel displays and announces* the system status.</p> <p>Arm instant: Pressing the AUX button while the exit delay is in progress will cause the system to arm "instant" - <u>the entry delay is canceled.</u></p> <p>Not Used: No function assigned to the AUX button.</p> <p>Stop Beeps: Pressing the AUX button will cause the control panel and other devices in the system (such as keyfobs, keypads, sirens etc.) to stop beeping (for example during exit or entry delays).</p> <p>Skip exit delay: Pressing the AUX button will immediately stop the exit delay and cause the system to arm instant.</p> <p>PGM: Pressing the AUX button will activate the PGM output. The functions of the PGM output is configured at the corresponding sections of the control panel's Installer Guide (see "OUTPUTS" menu) and User Guide (see "SCHEDULER" menu).</p> <p>* Applicable only to control panels that support the voice option.</p> <p>Note: PGM not to be enabled in UL Listed Product.</p>



3. USING THE KEYFOB

3.1 Arming the system

Step	Functions	User Actions
1	Arm AWAY	
	Arm HOME	
	Disarm (OFF)	
2	LATCHKEY	
3	Panic alarm	 (≈ 2 sec.)
4	AUX	

3.2 Panel Response to Keyfob Commands

When executing a command, the keyfob's LED blinks red once to indicate transmission of the command to the control panel. If the operation is **successfully completed**, the green LED lights momentarily and a "happy tune" is heard. If the operation **fails or cannot be completed**, for example, when the system is "not ready", the red LED lights steadily and a "sad tune" is heard.

Panel Response	Buzzer Indication	LED Indication
Success: Operation is successfully completed	 Happy (success) beep	Momentary GREEN
Fail: Operation failed	 Sad (failure) beep	Momentary RED
No communication: Control panel does not respond.	None	None

4. MAINTENANCE

4.1 Replacing the Battery

A replacement 3V battery, CR-2032, must be used only and is available from hardware and electrical supply stores. Replace the battery as shown in Figure 2. **Caution!** Battery May Explode If Mistreated. Do Not Recharge, Disassemble Or Dispose Of In Fire. Dispose of used batteries according to the manufacturer's instructions.

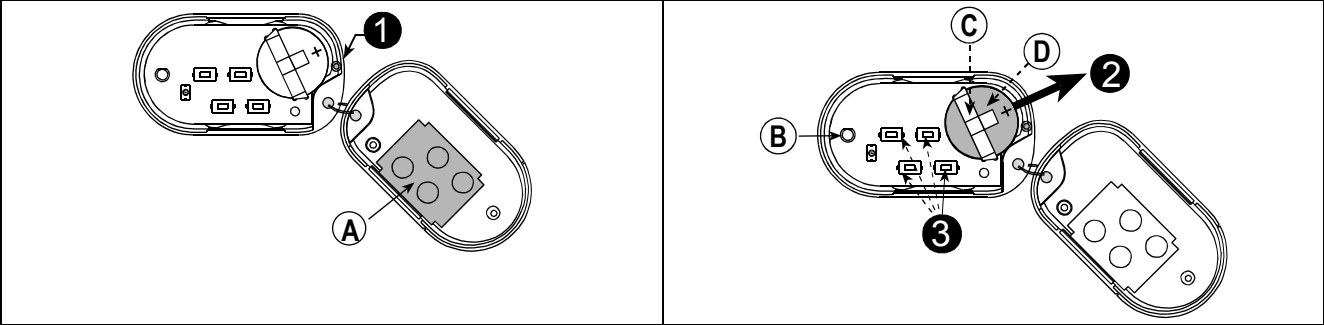

1. Remove backside screw and open the cover.
2. Using the screwdriver, push out the battery from its holder and install new battery (polarity "+" as shown).
3. Test the unit by momentarily pressing one of the Transmit buttons – the LED should light. Put back the cover and re-attach it with the screw.

- A. Button pad (make sure that it remains in its place).
- B. LED indicator.
- C. Battery holder.
- D. Battery

Figure 2: Battery Replacement

4.2 Cleaning

The keyfob may get dirty if touched with greasy fingers. Clean it only with a soft cloth or sponge moistened lightly with a mixture of water and mild detergent, and wipe it dry immediately.

The use of abrasives of any kind is strictly forbidden. Also never use solvents such as kerosene, acetone or thinner.

5. TESTING A NEW UNIT

Since the KF-234 PG2 is supplied with the battery already installed, the unit is practically ready to be tested.

- A. Stand 3 m (10 ft) away from a target control panel (or wireless control panel) and press the ARM AWAY button (see Fig. 1).
Verify that the red LED lights upon transmission and that the green LED lights upon acknowledgement from the control panel.
- B. Make sure that the control panel responds as programmed and as stated in the control panel's instruction manual.

6. PRODUCT LIMITATIONS

Visonic Ltd. wireless systems are very reliable and are tested to high standards. However, due to their low transmitting power and limited range (required by FCC and other regulatory authorities), there are some limitations to be considered:

- A. Control panels may be blocked by radio signals occurring on or near their operating frequencies, regardless of the code selected.
- B. Wireless equipment should be tested regularly to determine whether there are sources of interference and to protect against faults.

7. COMPLIANCE WITH STANDARDS

Compliance with Standards



Europe: EN 300220, EN 50131-1 Grade 2, Class II, EN 301489, EN 50130-4, EN 60950, EN 50131-6
Hereby, Visonic Ltd. declares that the radio equipment type KF-234 PG2 is in compliance with Directive 2014/53/EU.

The full text of the EU declaration of conformity is available at the following internet address:

<http://www.visonic.com/download-center>.

Certified by Norwegian accredited certification body Applica Test & Certification AS in accordance with EN 50131-3, EN 50131-6, EN 50131-5-3, EN 50130-4, and EN 50130-5.

Applica T&C has certified only the 868 MHz variant of this product.

USA: CFR 47 Part 15 (FCC)

Canada: RSS 210

UK: This product is suitable for use in systems installed to conform to PD6662 at Grade 2 and environmental class 2. BS8243

The Power G peripheral devices have two-way communication functionality, providing additional benefits as described in the technical brochure. This functionality has not been tested to comply with the respective technical requirements and should therefore be considered outside the scope of the product's certification.

EN 50131-1 Security Grade

According to EN 50131-1, this equipment can be applied in installed systems up to and including Security Grade 2.

EN 50131-1 Environmental Class Class II

Operation is subject to the following two conditions:

- (1) This device may not cause harmful interference, and
- (2) this device must accept any interference received, including interference that may cause undesired operation.

FCC Compliance Statement

This device has been tested and found to comply with the limits for a Class B digital device, pursuant to Part 15 of the FCC Rules. These limits are designed to provide reasonable protection against harmful interference in residential installations. This equipment generates uses and can radiate radio frequency energy and, if not installed and used in accordance with the instructions, may cause harmful interference to radio and television reception.

However, there is no guarantee that interference will not occur in a particular installation. If this device does cause such interference, which can be verified by turning the device off and on, the user is encouraged to eliminate the interference by one or more of the following measures:

- Re-orient or re-locate the receiving antenna.
- Increase the distance between the device and the receiver.
- Connect the device to an outlet on a circuit different from the one that supplies power to the receiver.
- Consult the dealer or an experienced radio/TV technician.

This equipment complies with FCC and IC RF radiation exposure limits set forth for an uncontrolled environment.

WARNING! Changes or modifications to this unit not expressly approved by the party responsible for compliance could void the user's authority to operate the equipment.

This device complies with FCC Rules Part 15 and with Industry Canada licence-exempt RSS standard(s). Operation is subject to two conditions: (1) This device may not cause harmful interference, and (2) this device must accept any interference that may be received or that may cause undesired operation.

Le présent appareil est conforme aux CNR d'Industrie Canada applicables aux appareils radio exempts de licence. L'exploitation est autorisée aux deux conditions suivantes : (1) l'appareil ne doit pas produire de brouillage, et (2) l'utilisateur de l'appareil doit accepter tout brouillage radioélectrique subi, même si le brouillage est susceptible d'en compromettre le fonctionnement.



W.E.E.E. Product Recycling Declaration

For information regarding the recycling of this product you must contact the company from which you originally purchased it. If you are discarding this product and not returning it for repair then you must ensure that it is returned as identified by your supplier. This product is not to be thrown away with everyday waste.
Directive 2002/96/EC Waste Electrical and Electronic Equipment.

APPENDIX: SPECIFICATIONS

Frequency Band (MHz)	Europe and rest of world: 433-434, 868-869 USA: 912-919* <i>Note: For UL Listed Product, enable this frequency band.</i> 10dBm @ 433MHz, 14dBm @ 868MHz.
Maximum Tx Power	PowerG
Communication Protocol	3V CR-2032 Lithium battery. (Panasonic, Varta, Sanyo, GP, Maxell)
Battery type	8 years (for typical use)
Battery Life Expectancy	2.2 V
Low Battery Threshold	Type C
Power Supply	<i>Note: If transmission is still possible despite the battery condition, the unit will send a low battery signal to the control panel.</i>
Transmitted Messages	Arm Away, Arm Home, Arm Latchkey, Disarm, AUX and Panic
Operating Temperature	0° to 55°C (32° to 131°F) <i>Note: For UL Listed product, the ambient temperature is 32°F to 120°F (0°C to 49°C)</i>
Humidity	Average relative humidity of approximate 75% non-condensing. For 30 days per year relative humidity may vary between 85 % and 95 % non-condensing <i>Note: For UL Listed product, the Relative Humidity is 93%</i>
Dimensions (LxWxD)	60 x 34.5 x 12.5 mm (2-3/8 x 1-3/8 x 1/2 in.)
Weight (including battery)	25 g (0.9 oz).
Color	Black

WARRANTY

Visonic Limited (the "Manufacturer") warrants this product only (the "Product") to the original purchaser only (the "Purchaser") against defective workmanship and materials under normal use of the Product for a period of twelve (12) months from the date of shipment by the Manufacturer.

This Warranty is absolutely conditional upon the Product having been properly installed, maintained and operated under conditions of normal use in accordance with the Manufacturers recommended installation and operation instructions. Products which have become defective for any other reason, according to the Manufacturers discretion, such as improper installation, failure to follow recommended installation and operational instructions, neglect, willful damage, misuse or vandalism, accidental damage, alteration or tampering, or repair by anyone other than the manufacturer, are not covered by this Warranty.

The Manufacturer does not represent that this Product may not be compromised and/or circumvented or that the Product will prevent any death and/or personal injury and/or damage to property resulting from burglary, robbery, fire or otherwise, or that the Product will in all cases provide adequate warning or protection. The Product, properly installed and maintained, only reduces the risk of such events without warning and it is not a guarantee or insurance that such events will not occur.

THIS WARRANTY IS EXCLUSIVE AND EXPRESSLY IN LIEU OF ALL OTHER WARRANTIES, OBLIGATIONS OR LIABILITIES, WHETHER WRITTEN, ORAL, EXPRESS OR IMPLIED, INCLUDING ANY WARRANTY OF MERCHANTABILITY OR FITNESS FOR A PARTICULAR PURPOSE, OR OTHERWISE. IN NO CASE SHALL THE MANUFACTURER BE LIABLE TO ANYONE FOR ANY CONSEQUENTIAL OR INCIDENTAL DAMAGES FOR BREACH OF THIS WARRANTY OR ANY OTHER WARRANTIES WHATSOEVER, AS AFORESAID.

THE MANUFACTURER SHALL IN NO EVENT BE LIABLE FOR ANY SPECIAL, INDIRECT, INCIDENTAL, CONSEQUENTIAL OR PUNITIVE DAMAGES OR FOR LOSS, DAMAGE, OR EXPENSE, INCLUDING LOSS OF USE, PROFITS, REVENUE, OR GOODWILL, DIRECTLY OR INDIRECTLY ARISING FROM PURCHASER'S USE OR INABILITY TO USE THE PRODUCT, OR FOR LOSS OR DESTRUCTION OF OTHER PROPERTY OR FROM ANY OTHER CAUSE, EVEN IF MANUFACTURER HAS BEEN ADVISED OF THE POSSIBILITY OF SUCH DAMAGE.

THE MANUFACTURER SHALL HAVE NO LIABILITY FOR ANY DEATH, PERSONAL AND/OR BODILY INJURY AND/OR DAMAGE TO PROPERTY OR OTHER LOSS WHETHER DIRECT, INDIRECT, INCIDENTAL, CONSEQUENTIAL OR OTHERWISE, BASED ON A CLAIM THAT THE PRODUCT FAILED TO FUNCTION.

However, if the Manufacturer is held liable, whether directly or indirectly, for any loss or damage arising under this limited warranty, **THE MANUFACTURER'S MAXIMUM LIABILITY (IF ANY) SHALL NOT IN ANY CASE EXCEED THE PURCHASE PRICE OF THE PRODUCT**, which shall be fixed as liquidated damages and not as a penalty, and shall be the complete and exclusive remedy against the Manufacturer.

When accepting the delivery of the Product, the Purchaser agrees to the said conditions of sale and warranty and he recognizes having been informed of.

Some jurisdictions do not allow the exclusion or limitation of incidental or consequential damages, so these limitations may not apply under certain circumstances.

The Manufacturer shall be under no liability whatsoever arising out of the corruption and/or malfunctioning of any telecommunication or electronic equipment or any programs.

The Manufacturers obligations under this Warranty are limited solely to repair and/or replace at the Manufacturer's discretion any Product or part thereof that may prove defective. Any repair and/or replacement shall not extend the original Warranty period. The Manufacturer shall not be responsible for dismantling and/or reinstallation costs. To exercise this Warranty the Product must be returned to the Manufacturer freight pre-paid and insured. All freight and insurance costs are the responsibility of the Purchaser and are not included in this Warranty.

This warranty shall not be modified, varied or extended, and the Manufacturer does not authorize any person to act on its behalf in the modification, variation or extension of this warranty. This warranty shall apply to the Product only. All products, accessories or attachments of others used in conjunction with the Product, including batteries, shall be covered solely by their own warranty, if any. The Manufacturer shall not be liable for any damage or loss whatsoever, whether directly, indirectly, incidentally, consequentially or otherwise, caused by the malfunction of the Product due to products, accessories, or attachments of others, including batteries, used in conjunction with the Products. This Warranty is exclusive to the original Purchaser and is not assignable.

This Warranty is in addition to and does not affect your legal rights. Any provision in this warranty which is contrary to the Law in the state or country where the Product is supplied shall not apply.

Warning! The user must follow the Manufacturer's installation and operational instructions including testing the Product and its whole system at least once a week and to take all necessary precautions for his/her safety and the protection of his/her property.

01/08



EMAIL: info@visonic.com

INTERNET: www.visonic.com

©VISONIC LTD. 2019 D-302416 KF-234 PG2 (Rev 5, 01/19)



D-302416