

## Product presentation

The SEV Intercom Siren is designed for use with a W Videofied® wireless alarm system.

Its main features are :

- Completely wireless and powered with alkaline batteries : 4 years battery life.
- Dual tamper function provides detection for both wall and cover tamper.
- Transmits check-in/status signals every 8 minutes
- 101 dBA output level at 1m.
- Adjustable siren duration (according to local legislation).
- Embedded microphone and speaker for half-duplex intercom.



## Programming / RF Testing

The following provides summarized steps for device programming and testing. For complete details, refer to the control panel installation manual.

- 1 Remove the locking screws, open the box and insert 4 LR20 alkaline batteries.

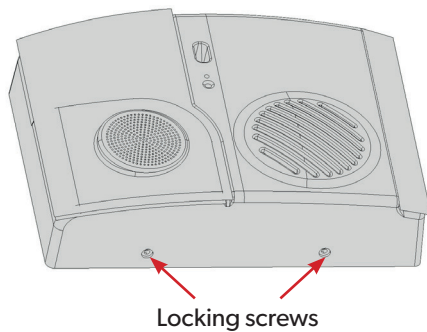

- 2 With the programming keypad, browse to the ADD A NEW DEVICE menu (Level 4).

- 3 Press OK/YES. The keypad displays PRESS PROGRAM BUTTON OF DEVICE.

- 4 Press and release the intercom siren INIT button.

The status LED flashes. Wait for the keypad display to show INTERCOM SIREN (1-24) RECORDED.

- 5 Press OK/YES. The display shows RADIO RANGE TEST?

Press OK/YES again to run the test. The keypad display shows TEST IN PROGRESS.

- 6 Place the intercom siren at the planned install location. Please ensure that the device status LED flashes. The test result must stabilize at 8/9 minimum.

## Installation guidelines

For easier installation, programming and RF testing should be done to check for good communication between the control panel and all system devices before mounting system devices. Install the siren and other system devices in the order of the following steps :

- > Mounting - mount the intercom siren at the tested location.

- > Programming/RF Testing - program the intercom siren and all other devices into the control panel and test RF communication from each intended device location to the control panel.

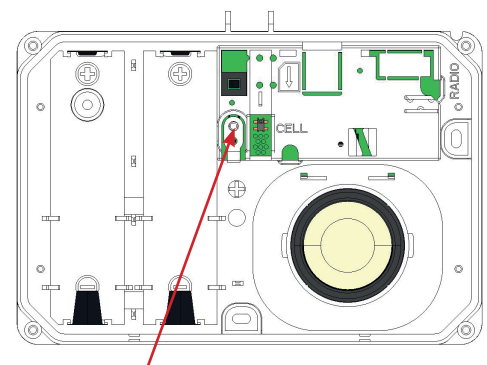

- 7 Press OK/YES to end the radio range test then ESC NO.

- 8 When finished, exit from configuration mode by a long press on ESC NO.

## Mounting

- > Use proper tools and hardware.

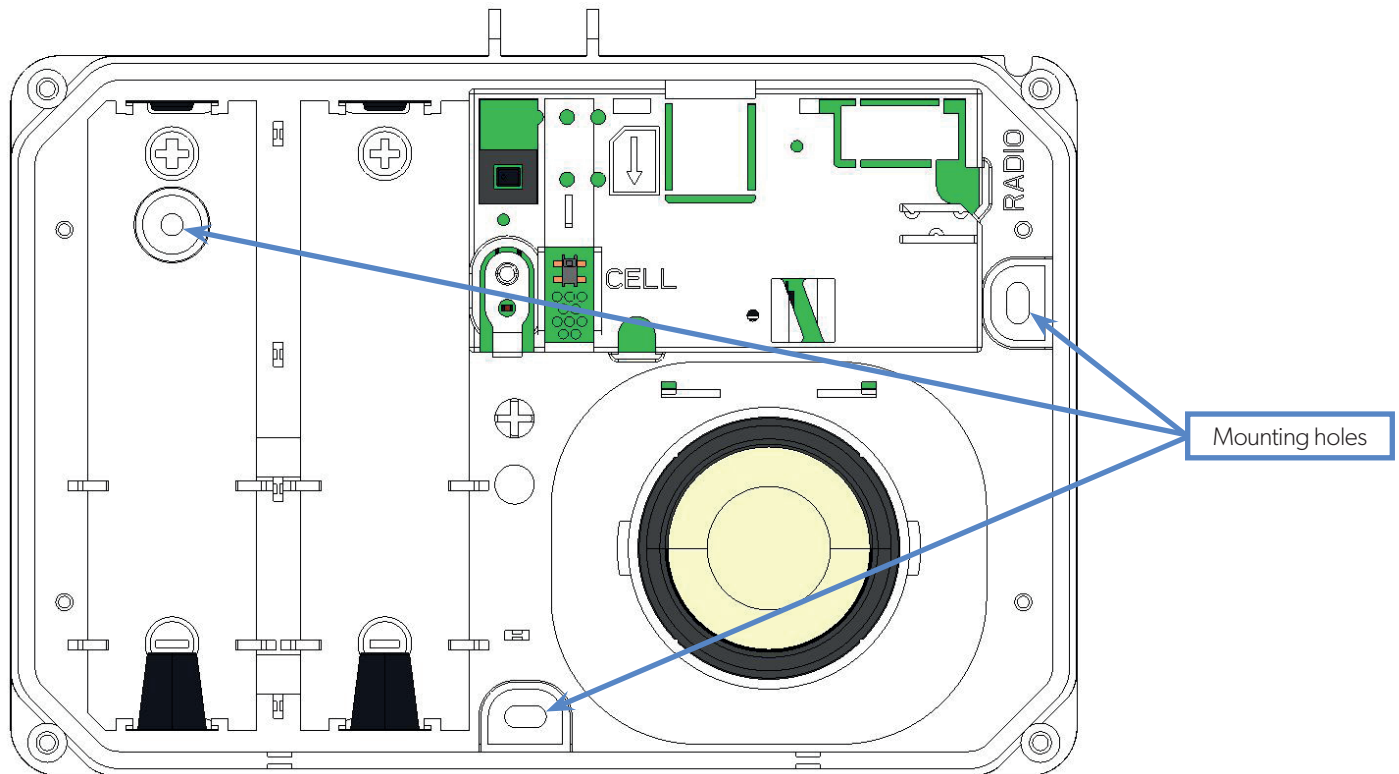

- 1 Open the box and remove the batteries
- 2 Hold up the intercom siren base against the mounting surface and mark the three mounting holes..
- 3 Drill pilot holes and install anchors where needed.
- 4 Place unit on mouning surface so mounting holes line up with pilot holes/anchors and secure unit with appropriate screws.
- 5 Insert 4 LR20 1.5V, observing correct polarity.
- 6 Attach front cover and lock with the screws.

## Intercom operation

Voice transmission uses the samed radio channel used byt the panel and the devices. The intercom is therefore half-duplex.

- > When the intercom starts, the monitoring station operator will be in listening mode.
- > Than the operator switches to speaking mode to summon the person on site.
- > When the intercom siren switches back to listening mode, it will emit a bip, indicating that the intruder can identify himself.
- > The monitoring station operation can switch between liseting and speaking mode in order to identify the intruder.

# SEV 200 REMOTE INTERCOM SIREN

## Use only the siren or only the intercom

By default, the siren and the intercom are both enabled. You can enable one or the other

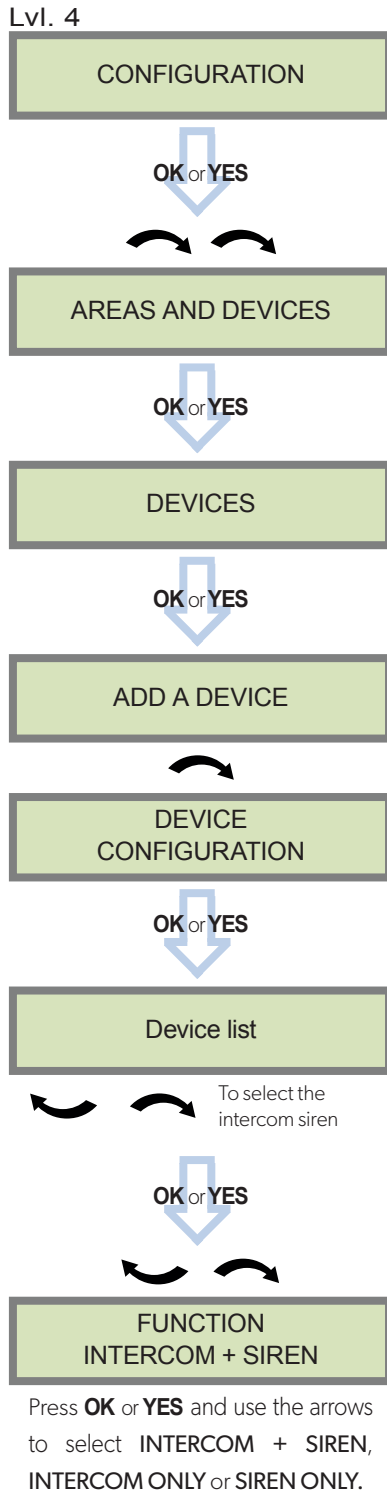

## Register several intercom sirens

Several intercom sirens can be registered in a single Videofied® alarm panel. However, only one SEV at a time can be activated.

Every detection device is linked to an intercom siren. When an intrusion occurs, the first detector that triggered an intrusion will activate the SEV associated with it.

Example : Cameras 1 & 2 are associated with SEV1. Door contact 1 is associated with SEV2.

- If Camera 1 triggers the first intrusion, SEV1 will be used.
- If Door contact 1 triggers the first intrusion, SEV2 will be used.

By default every device is associated with the first SEV registered. You can choose the detectors associated with each intercom siren in the DEVICE ASSOCIATION menu.

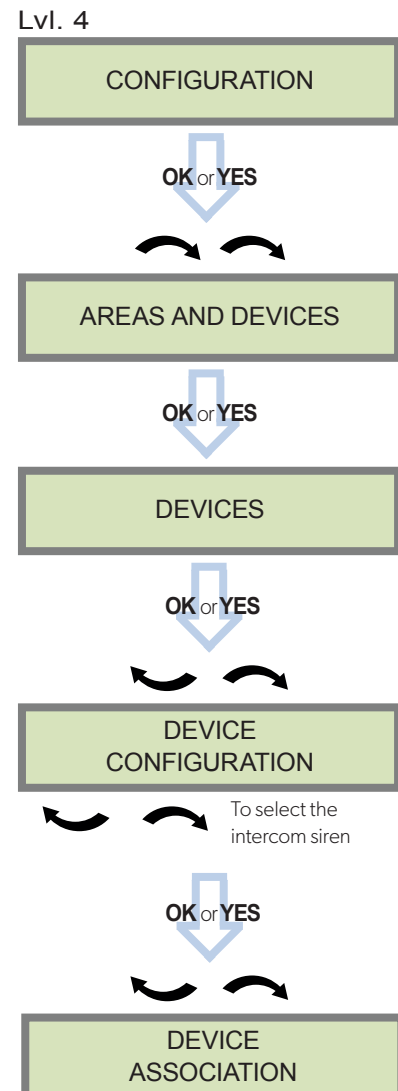

Those functions are only available for panel firmware versions **04.06.XX.XXX** and later.



# SEV 200 REMOTE INTERCOM SIREN

## Security notes / (FR) Notes de sécurité / (DE) Hinweise zur Sicherheit

### English

- Remove the batteries before any maintenance !
- **WARNING, there is a risk of explosion if a battery is replaced by an improper model !**
- Observe polarity when setting up the batteries!
- Do not litter the batteries when they are used! Dispose of it properly according to Lithium Metal requirements

### Français

- Retirez les piles avant toute opération de maintenance !
- **Attention ! Il y a un risque d'explosion si la batterie utilisée est remplacée par un mauvais modèle !**
- Respectez la polarité lors de la mise en place des piles !
- Ne jetez pas les batteries usagées ! Ramenez-les à votre installateur ou à un point de collecte spécialisé.

### Deutsch

- Batterien vor jeglichen Wartungsarbeiten entfernen!
- **Vorsicht, es besteht Explosionsgefahr, wenn eine Batterie durch eine Batterie falschen Modells ersetzt wird!**
- Achten Sie beim Einsetzen der Batterien auf die Polung!
- Entsorgen Sie Batterien nicht im normalen Haushaltsmüll! Bringen Sie Ihre verbrauchten Batterien zu den öffentlichen Sammelstellen.

## ELECTRICAL DATA

<b>Panel compatibility</b>	W and WIP
<b>Power requirements</b>	Type C - 4x 1,5V D/LR20 Alkaline batteries
Nominal voltage	6V
Low battery limit	4.2V
Battery life	4 years with 75 alarms
<b>Current consumption</b>	
Standby	250 $\mu$ A
Siren mode	160 mA max
Intercom mode	280 mA max
<b>RF S2View® technology</b>	
Radio type	Spread spectrum bidirectional RF
Operating frequency	868MHz - SEV 200 (Europe, Africa, Asia)
Transmission security	AES encryption algorithm
Supervision	Radio, batteries, tamper
Radio antenna	Integrated
<b>Siren Buzzer</b>	
Average power level	101 dBA at 1m
Max siren duration	15 min (according to local legislation)
<b>Microphone (intercom)</b>	
Type	MEMS omnidirectional
Sensitivity	-42 dBV/Pa
Max impedance	120 dB SPL
<b>Speaker (intercom)</b>	
Output level	1.5 W
Average acoustic level	91.5 dBA
Impedance	4 $\Omega$
<b>Tamper detection</b>	
	Wall and cover tamper

## BOX

<b>Physical properties</b>	
Material	Plastic : White ABS UL94V0
Dimensions	228 mm x 168 mm x 60 mm (LxWxD) : 9 in. x 6.61 in. x 2.36 in.
Weight	735 g/26 oz. (without batteries)
<b>Environmental properties</b>	
Operating temperature	-10°/+55°C (+14°/+131°F)
Max relative humidity	75%, sans condensing
Protection marking	IP31 / IK04
Material	ABS UL94V0 white plastic
<b>Installation / Mounting</b>	
Wall / Cover	Four screws secure siren base to mounting surface Two side screws for cover locking

## STANDARDS & CERTIFICATIONS



EN50131-4	Grade 2 -- Type W
NF EN50131-4	2009 Grade 2 -- Type W
NF EN50130-4	2011
NF EN50130-5	2011 Environment class II

### Matériels de sécurité électronique, détection d'intrusion

#### DISPOSITIF D'ALARME SONORE

Marque commerciale	Videofied
Référence produits	SEV200
N° de certification	

**Organisme certificateur :**  
**CNPP Cert.**  
 Route de La Chapelle Réanville CS22265  
 F-27950 SAINT MARCEL  
 Tel : +33(0)2.32.53.63.63  
 Fax: +33(0)2.32.53.64.46  
 Sites Internet : <http://www.cnpp.com>  
 Email : [certification@cnpp.com](mailto:certification@cnpp.com)

**Organisme certificateur :**  
**AFNOR Certification**  
 11, rue François de Pressensé  
 93571 Saint Denis La Plaine Cedex  
 Tel : +33(0)1.41.62.80.00  
 Fax: +33(0)1.49.17.90.00  
 Sites Internet : <http://www.afnor.org>  
 et <http://www.marque-nf.com>  
 E-mail : [certification@afnor.org](mailto:certification@afnor.org)

### EMEA SALES

23, avenue du Général Leclerc  
 92340 BOURG-LA-REINE  
 FRANCE  
 E-Mail : [emeasales@rsivideotech.com](mailto:emeasales@rsivideotech.com)

### North American Headquarters

1375 Willow Lake Blvd, Suite 103  
 Vadnais Heights, MN 55110  
 USA  
 E-Mail : [usasales@rsivideotech.com](mailto:usasales@rsivideotech.com)

